



# AREA 57



**AREA 57**  
by EPIC

## COMMERCIAL SPACE AVAILABLE

### ADDRESS

202 E Greenfield Ln. Bismarck, ND 58503

### PROPERTY DETAILS

<b>Available:</b>	Now Available
<b>Commercial SF:</b>	20,000+ SF
<b>Building Size:</b>	4 Stories
<b>Lease Rate:</b>	\$21/SF + CAM
<b>Lease Term:</b>	5 Years
<b>Fit-up Allowance</b>	\$25/SF

Subdivided space available, Contact for more Information





# AREA 57 by EPIC

202 E Greenfield Ln. Bismarck, ND 58503

## NEIGHBORHOOD FEATURES

### POPULATION

.5 mi.  
61  
people

1 mi.  
2,257  
people

3 mi.  
28,099  
people

### BUSINESSES

.5 mi.  
5  
businesses

1 mi.  
43  
businesses

3 mi.  
1,121  
businesses

### EMPLOYEES

.5 mi.  
67  
employees

1 mi.  
547  
employees

3 mi.  
15,525  
employees

Source: ESRI Business Analysis



BUILDING C

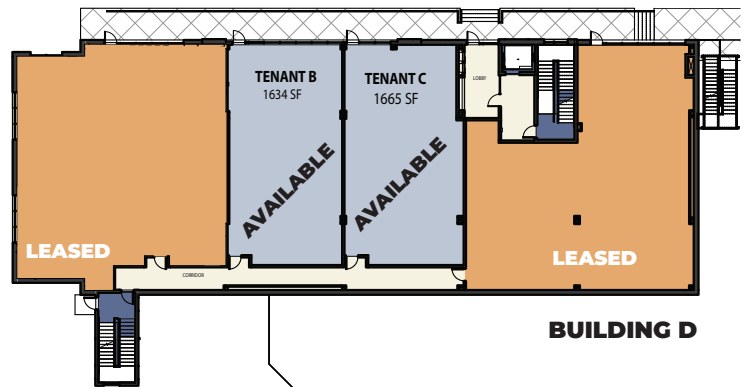

BUILDING D



Right between the Bismarck Surgical Associates Center and Light of Christ High Schools



Investment • Development • Management

701.866.1006

EPICCompaniesND.com



# AREA 57 by EPIC

202 E Greenfield Ln. Bismarck, ND 58503

## OVERVIEW

AREA 57 is a master-planned mixed-use development that will cater to the growing demand for all lifestyle communities.

AREA 57 will serve as a multi-purpose environment where living, shopping, working, playing and socializing coexist. The first phase of AREA 57 is buildings C and D. Building C will have 27 apartments, both 1 and 2-story units, and 12,746 sf of commercial space. Building D will have 25 apartments and 8,728 sf of commercial space. Some property highlights include an outdoor programmable park, health and wellness focused businesses along with a mix of retail to support the residential and commercial tenants. The buildings will have an attractive and modern design. AREA 57 will be a prominent building complex that will give Bismarck residents an area where people can work, live, and play.



Construction progress picture June. 2020

## CONTACT



### Blake Nybakken

Vice President of Development

701.721.8047

Blake@EPICCompaniesND.com

# AREA 57



# 701.866.1006

EPICCompaniesND.com