



TAB 42

Fargo, ND

TAB
42
BY EPIC

COMMERCIAL SPACE AVAILABLE

ADDRESS

4207 28th Avenue S, Fargo, ND 58104

PROPERTY DETAILS

Lease Rate	\$18/SF
CAM	\$6.50/SF
Total Space	11,000± SF
Space Available	NA
Lease Term	5 Years
Year Built	2022
Floors	1st & 2nd Floors
Style	Office
Fit-up Allowance	\$25/SF

Subdivided space available. Details and rates are subject to change at any time. Contact for more information.

701.866.1006

EPICCompaniesND.com

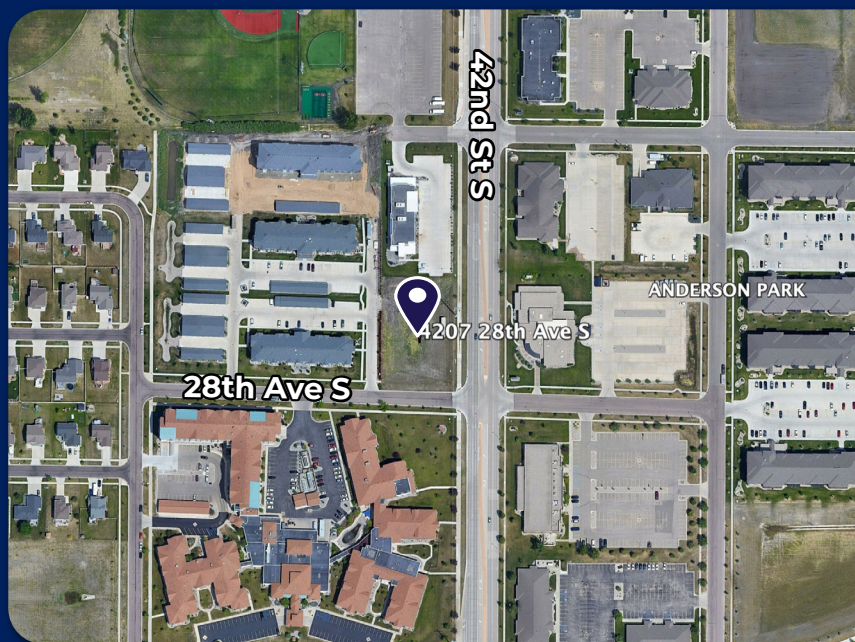



TAB 42

4207 28th Ave S, Fargo, ND 58104

1st Floor



2nd Floor

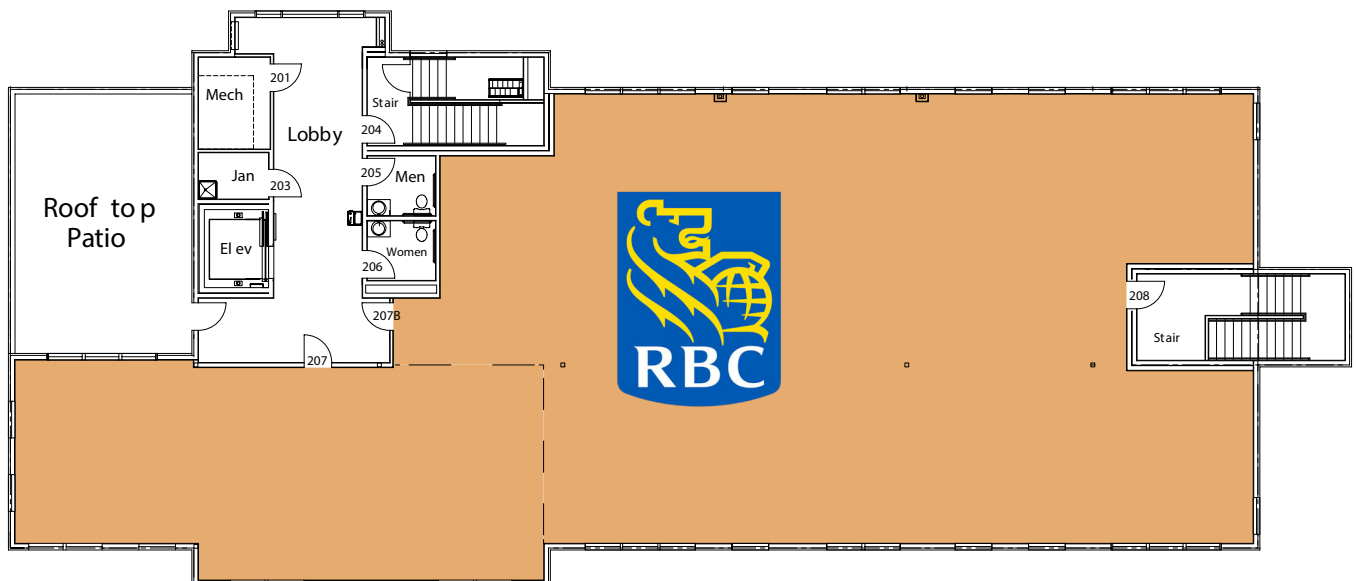



TAB 42 PROJECT OVERVIEW

4207 28th Avenue S, Fargo, ND 58104



OVERVIEW

TAB 42 is a commercial rental building in Fargo, ND. This space will provide an opportunity to serve any type of business. This property will include 2 stories of commercial space with a rooftop patio! TAB 42 will be completed summer 2022.

Features

- Digital Monument Sign
- Established Business District
- Spacious Parking Lot
- Rooftop Patio

Nearby Locations of Interest

- Bars & Restaurants
- Red River Zoo
- Parks
- Residential Communities

NEIGHBORHOOD FEATURES

Population (No. of People)		
.5 mile	1 mile	3 miles
1,961	10,748	102,312

Business (No. of Businesses)		
.5 mile	1 mile	3 miles
134	404	4,121

Employees (No. of Employees)		
.5 mile	1 mile	3 miles
2,238	7,063	67,481

Source: ESRI Business Analysis



Zach Frappier
Director of Realty
701.388.6919 | Zach@EPICCompaniesND.com

