



JP Place
Perham, MN



SPRING OWNERS SPECIAL
LEASE RATE: \$15/SF + CAM AND NO TIA

COMMERCIAL SPACE AVAILABLE

ADDRESS

210 Main St. Perham, MN 56573

PROPERTY DETAILS

Lease Rate	\$17/SF
CAM	\$6.50/SF
Total Space	8,300± SF
Space Available	6,200± SF
Lease Term	5 Years
Date Available	2023
Style	Mixed-Use
Fit-up Allowance	\$25/SF

Subdivided space available. Details and rates are subject to change at any time. Contact for more information.

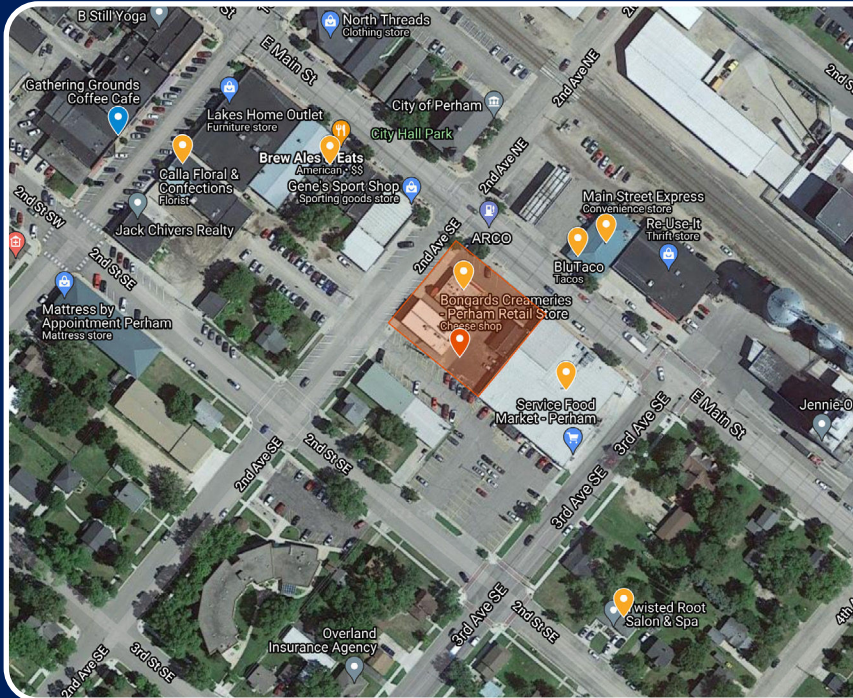

701.866.1006
EPICCompaniesND.com





JP Place Project Overview

210 Main St. Perham, MN 56573

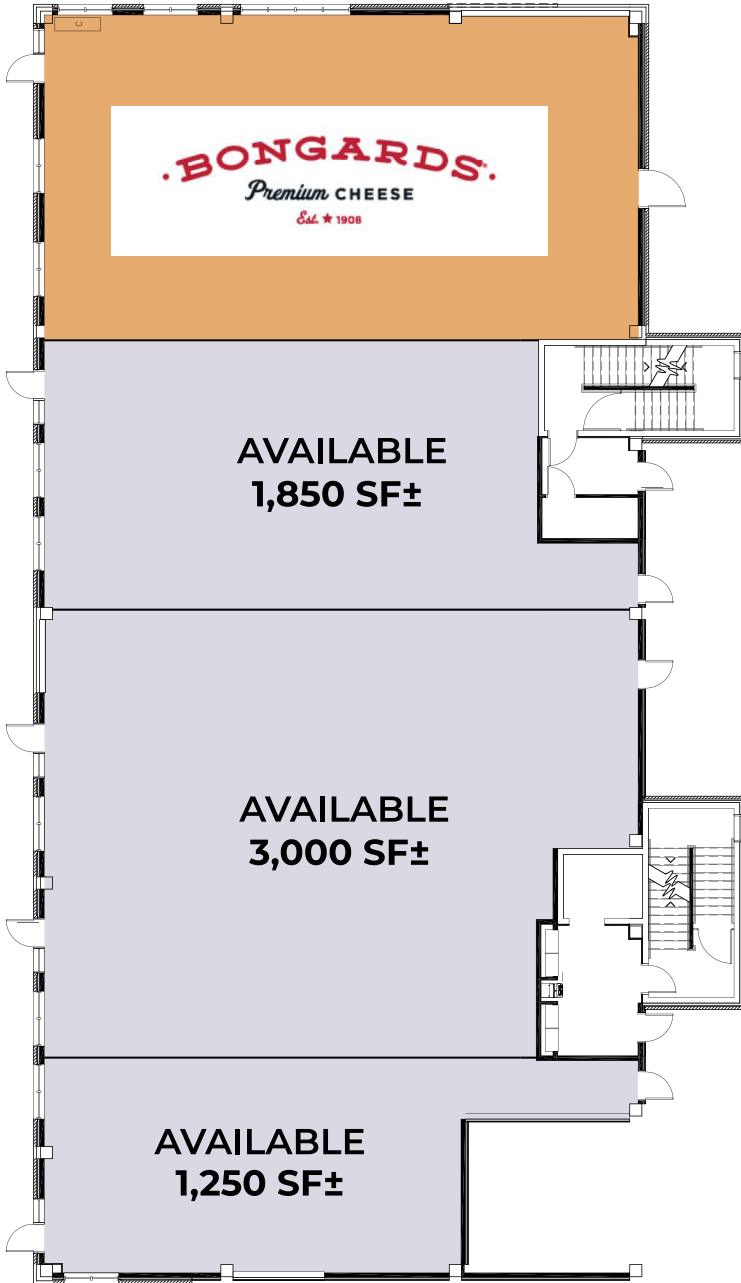

OVERVIEW

The project will be a brand new mixed-use building with commercial and residential units. JP Place will be people focused with a community room, workout facility, and underground parking for tenants. Along with these amenities the mixed-use building will cater to the small, vibrant community that is actively on the grow.

Perham attracts many families with a great school system, outdoor recreation, shops, restaurants, and more. JP Place will cater to both residential and commercial along with the customers visiting these businesses. Enjoy the many attractions of a big city with a hometown feel.

NEIGHBORHOOD FEATURES

Population (No. of People)		
.5 mile	1 mile	3 miles
1,743	3,155	4,335

Business (No. of Businesses)		
.5 mile	1 mile	3 miles
240	359	429

Employees (No. of Employees)		
.5 mile	1 mile	3 miles
3,184	4,737	5,325

Source: ESRI Business



Zach Frappier
Director of Realty



BUY | SELL | INVEST
TRIOLOGY
REAL ESTATE
LOCATED AT 1010 MAIN AVE FARGO, ND

701.388.6919 | Zach@EPICCompaniesND.com



Investment • Development • Management